

DATE PLOTTED: 4/1/2024 8:09:35 PM
 CAD FILE: P:\301249110\Project Documentation\Civil Drawings & Design\Plan Retaining Wall.dgn

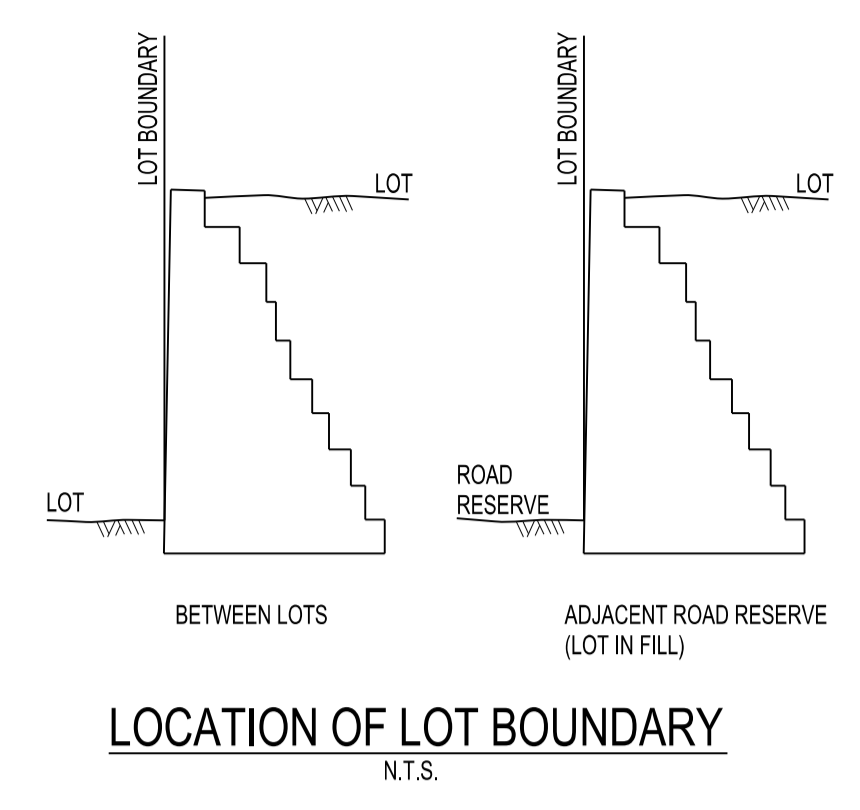

- NOTES
- BLOCKS SHALL BE RECONSTITUTED LIMESTONE WITH A MINIMUM DRY DENSITY OF 1500 KG/m
 - ALL LIMESTONE BLOCKS TO BE TUNGSTEN CUT & PALLETISED.
 - ALL LIMESTONE BLOCKS TO BE FULLY JOINTED WITH MORTAR (MINIMUM 1:1:6 CEMENT:LIME:SAND RATIO).
 - MORTAR JOINTS TO BE 20mm WIDE FINISHED FLUSH WITH A RULED JOINT. TOP COURSE OF WALL TO HAVE FLUSH JOINTS ON TOP SURFACE ONLY.
 - COMPACTED SAND BACKFILL TO WALLS IN 300mm LAYERS TO NOT LESS THAN 95% MDD TO AS1289 E2.1.
 - LIMESTONE BLOCKS TO BE SELECTED ON SITE TO ENSURE THAT ONLY CLEAN SQUARE EDGES FREE FROM MAJOR CHIPS ARE VISIBLE IN TOP COURSE AND FACEWORK.
 - LIMESTONE BLOCKS TO BE LAID IN A STRETCHER BOND PATTERN.
 - WALL TO BE FULLY PROPPED PRIOR TO BACKFILL AND COMPACTION.
 - COMPACT GROUND IN FRONT OF WALL PRIOR TO BACKFILL AND COMPACTION.
 - ALL BACKFILL TO BE FREE DRAINING CLEAN SAND, FREE OF DELETERIOUS MATTER.
 - FOOTING SUBGRADE TO BE COMPACTED TO 95% MDD BEFORE LAYING LIMESTONE BLOCK.
 - CONTRACTOR SHALL CONFIRM FINISHED VERGE LEVEL BEFORE COMMENCING RETAINING WALL CONSTRUCTION ADJACENT TO VERGES.
 - RETAINING WALL SETOUT DRAWING TO BE READ IN CONJUNCTION WITH DRAWINGS CI-202-RW-1, L2, CI-206-RW-D1, D2, D3, D4, D5, D6 & D7.
 - CONTRACTOR TO PROVIDE CONSTRUCTION JOINT CONNECTION TO EXISTING WALL.
 - RUBBLE SHALL NOT BE USED TO FILL VOIDS UNLESS OTHERWISE NOTED. RECONSTITUTED BLOCKS SHALL BE USED FOR PACKING BLOCKS. ALL BLOCKS SHALL BE LAID IN ACCORDANCE WITH DETAIL STD-WGE/STD1
 - NON-SACRIFICIAL ANTI-GRAFFITI COATING SHALL BE APPLIED TO ANY WALLS EXPOSED TO ROAD FRONTAGE, P.O.S. OR SCHOOLS. CONTRACTOR SHALL PROVIDE CERTIFICATION THAT COATING HAS BEEN APPLIED AND ISSUE CLEANING SPECIFICATION TO SUPERINTENDANT FOR LODGEMENT WITH COUNCIL PRIOR TO PRACTICAL COMPLETION
 - ALL RETAINING WALL STUBS EXTENDING INTO FUTURE LOTS ARE TO BE 5m LONG UNLESS NOTED OTHERWISE.

- LEGEND:
- 18.74 PROPOSED PAD LEVEL
 - 13.20 EXISTING PAD LEVEL
 - 13.20 FUTURE PAD LEVEL
 - RET 1 RETAINING WALL LONGSECTION REFERENCE NAME
 - PROPOSED RETAINING WALL CENTRELINE (TO BE CONSTRUCTED IN THIS CONTRACT)
 - PROPOSED CANTILEVER WALL
 - FUTURE RETAINING WALL
 - EXISTING RETAINING WALL
 - START OF RETAINING WALL LONGSECTION
 - END OF RETAINING WALL LONGSECTION
 - BATTER LINE
 - WORKS BOUNDARY
 - PROPOSED ROAD KERB
 - EXISTING ROAD KERB
 - FUTURE ROAD KERB
 - EXISTING TREES
 - RETAINING WALL HEIGHT - EXPOSED COURSING
 - EXISTING HV POWER
 - CONTROL JOINT - REFER TO DRAWING CI-206-RW-D1 FOR DETAIL

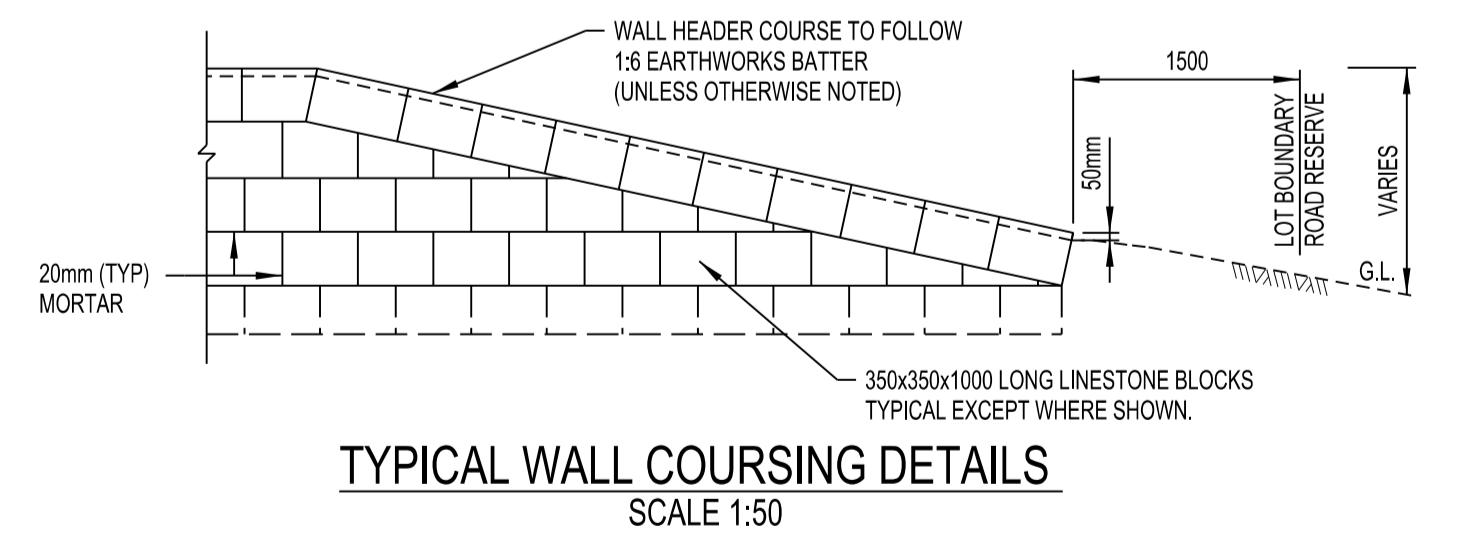

REV	DESCRIPTION	DRAWN	APPD	DATE
B	RETAINING WALLS ADDED	KLJ	MDI	
A	PRELIMINARY ISSUE	KLJ	MDI	

DEVELOPMENT WA

ARCHITECT/CIENT

JANE BROOK - STAGE 3A
 RETAINING WALL PLAN

PROJECT/TITLE

Stantec CIVIL

156999	PCG94	mAHD	1:500	301249110	CI-200-RW-P1	B
WPC	COORDS	DATUM	SCALE @ A1	PROJECT No	DRAWING No	REV



THIS DRAWING HAS BEEN DOCUMENTED IN COLOUR. THIS DRAWING IS REQUIRED TO BE PRINTED COLOUR. FAILURE TO DO SO MAY RESULT IN LOSS OF INFORMATION. BLACK & WHITE PRINTING MAY BE USED ONLY IF SPECIFIC BLACK & WHITE DOCUMENTS HAVE BEEN OBTAINED FROM STANTEC.