

SURVEY-STRATA PLAN
69299
 SHEET 1 OF 1 SHEET

VERSION: _____ AMENDMENT: _____ AUTHORISED BY: _____ DATE: _____

PLAN OF
LOT 57 ON P 9344(2)

CERTIFICATE OF TITLE
 Vol. 256 Fol. 29A

LOCAL GOVERNMENT
 CITY OF STIRLING

INDEX PLAN
 SEE SMARTPLAN

FIELD BOOK
 128406

SCALE
 1:300 @ A3

NAME OF SCHEME
**31 KEEBLE WAY,
 BALGA**

ADDRESS OF PARCEL
**31 KEEBLE WAY,
 BALGA, 6061**

MANAGEMENT STATEMENT YES NO

LOGGED
 CERTIFIED CORRECT *W.M. Scanlan* 27-Oct-14

DATE
 25-Sep-14

FEE PAID
 \$540.00

ASSESS No.
 15929390

FOR REGISTRAR OF TITLES DATE
 13-Feb-15

REGISTERED
 APPLICATION
 DATE
 19.3.2015

REGISTRAR OF TITLES
 SEAL

WESTERN AUSTRALIAN PLANNING COMMISSION
 Certificate of Approval of W.A.P.C. under Section 25B(2) of
 Strata Titles Act 1985

Delegated under s.19 PBD Act 2005

13-Feb-2015
 DATE

LANDGATE
 Western Australian Land Information Authority

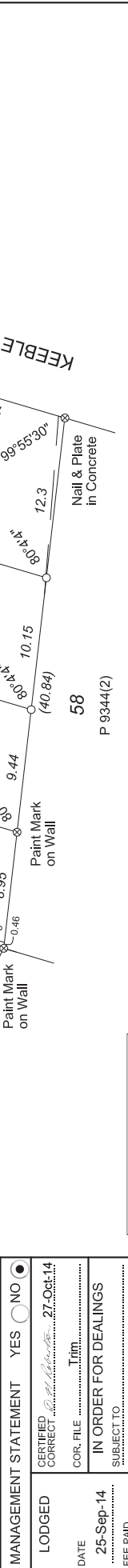

PLAN APPROVED
W.M. Scanlan 13-Feb-15
 Director of Land Information
 (Section 18, Landmark Surveyors Act 1997)

SCANLAN SURVEYS PTY LTD
 LICENSED SURVEYORS
 P O BOX 429 MIDLAND 6936
 PH: 08 9250 2261 FAX: 08 9274 6206
 Email: bill@scanlansurveys.com.au
 7320/14/2 LF

SURVEYORS CERTIFICATE - Reg 54
 I, **W.M. SCANLAN**
 hereby certify that this plan is accurate and is a correct
 representation of the land shown.
 (a) "super" and/or
 (b) "calculations from measurements recorded
 in the field records."
 [delete if applicable]
 undertaken for the purposes of this plan and that it complies
 with the relevant written law(s) in relation to which it is lodged.
 2014.02.24
 1300 to 4800
 DATE
 LICENSED SURVEYORS

INTERESTS AND NOTIFICATIONS		INTERESTS AND NOTIFICATIONS				
SUBJECT	PURPOSE	STATUTORY REFERENCE	ORIGIN	LAND BURDENED	BENEFIT TO	COMMENTS
(X)	MINERAL RESERVATION	SEC 15 OF THE PWA	THIS PLAN	ALL LOTS	WATER CORPORATION	
(33b)	EASEMENT (SEWERAGE)	SEC 167 OF THE P&D ACT, REG 33(b)	THIS PLAN	LOT 4	LOT 1	
(A)	EASEMENT (TRANSMISSION OF ELECTRICITY BY UNDERGROUND CABLE)	SEC 136C OF THE TLA	THIS PLAN	LOT 2	LOT 4	
(B)	EASEMENT (TRANSMISSION OF UNDERGROUND CABLE)	SEC 136C OF THE TLA	THIS PLAN	LOT 3	LOT 4	

**HELD BY LANDGATE
 IN DIGITAL FORM ONLY.**

FORM 3

SURVEY-STRATA PLAN No. 69299							
Schedule of Unit Entitlement		Office Use Only		Schedule of Unit Entitlement		Office Use Only	
		Current Cs of Title				Current Cs of Title	
Lot No,	Unit Entitlement	Vol.	Fol.	Lot No,	Unit Entitlement	Vol.	Fol.
1	25	2865	- 403				
2	25	2865	- 404				
3	25	2865	- 405				
4	25	2865	- 406				
				Aggregate	100		

DESCRIPTION OF PARCEL

FOUR SURVEY-STRATA LOTS UPON LOT 57 ON PLAN 9344(2)
 ADDRESS OF PARCEL: 31 KEEBLE WAY, BALGA WA 6061

**CERTIFICATE OF LICENSED VALUER
 SURVEY-STRATA**

I, **Bradley J Dawson**, being a Licensed Valuer licensed under the *Land Valuers Licensing Act 1978* certify that the unit entitlement of each lot (in this certificate, excluding any common property lots), as stated in the schedule bears in relation to the aggregate unit entitlement of all lots delineated on the plan a proportion not greater than 5% more or 5% less than the proportion that the value (as that term is defined in section 14 (2a) of the *Strata Titles Act 1985*) of that lot bears to the aggregate value of all the lots delineated on the plan.

22-Sep-2014
Date

 Digitally signed by
 Brad Dawson
 Date: 2014.09.22
 12:40:43 +08'00'
 Signed

ANNEXURE 'A' OF SURVEY-STRATA PLAN NO. 69299

REGISTRAR OF TITLES

SCHEDULE OF DEALINGS

Deals registered or recorded on Survey-Strata Plan	Instrument			Signature of Registrar of Titles
	Nature	Number	Registered	
EASEMENT BENEFIT CREATED UNDER SECTION 136C TLA FOR UNDERGROUND ELECTRICITY PURPOSES - SEE SURVEY-STRATA PLAN 69299				

SCHEDULE OF ENCUMBRANCES ETC.

Instrument	Particulars	Registered	Signature of Registrar of Titles	Cancellation	Signature of Registrar of Titles
	EASEMENT BURDEN CREATED UNDER SECTION 167 P. & D. ACT FOR SEWERAGE PURPOSES TO WATER CORPORATION - SEE SURVEY-STRATA PLAN 69299				
	EASEMENT BURDEN CREATED UNDER SECTION 136C TLA FOR UNDERGROUND ELECTRICITY PURPOSES - SEE SURVEY-STRATA PLAN 69299				

Note: Entries may be affected by subsequent endorsements.